

FLUKE®



Fluke Solar Tools

Fluke Solmetric PVA-1500 Series Kits

The Fluke Solmetric PVA-1500 Series offers a powerful and efficient solution designed for I-V curve tracing and PV performance verification in solar PV arrays, providing accurate and fast measurements, ease of use, and advanced HE features (HE2 model) to maximize the return on investment for PV systems.

We are now able to offer more value to Solar Technicians, particularly in the utility-scale, by bundling the PVA-1500 with top-of-the-line Fluke clamp meters, multimeters, thermal cameras, and insulation resistance testers, as well as on-demand training and Fluke Premium Care.



Kits shown on back



PVA I-V Curve Tracer



Includes PVA-1500T2
PV Analyzer
PVA-1500T2

High Efficiency PVA I-V Curve Tracer



Includes PVA-1500HE2
PV Analyzer
PVA-1500HE2

DMM and Clamp Kit



Includes PVA-1500HE2
PV Analyzer, 393 FC Solar
Clamp Meter, and 87V
Industrial Multimeter
FLUKE-SOL-DMM87V-KIT

Thermographers Kit



Includes PVA-1500HE2
PV Analyzer and
TiS75+ Thermal Camera
FLUKE-SOL-TI-27HZKIT

Insulation Testing Kit 2500V



Includes PVA-1500HE2
PV Analyzer and 1537
Insulation Resistance Tester
FLUKE-SOL-INS37-KIT

Insulation Testing, DMM and Clamp Kit



Includes PVA-1500HE2
PV Analyzer, 393 FC Solar
Clamp Meter, 1587 Insulation Multimeter,
and 87V Industrial Multimeter
FLUKE-SOL-INS87-KIT

Training Kits

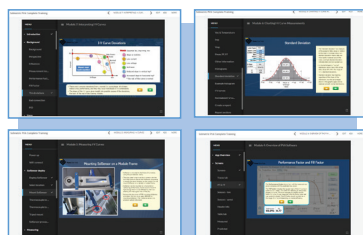

On-demand Solmetric PVA Complete Training



Includes PVA-1500T2 PV Analyzer
and single seat license to access
on-demand PVA training
FLUKE-PVA-1500T2/TR



Includes PVA-1500HE2 PV Analyzer
and single seat license to access
on-demand PVA training
FLUKE-PVA-1500HE2/TR

Premium Care Kits



Accidental damage
and repair



Replacement of damaged
accessories



Annual tool inspection,
calibration, cleaning,
and updating



Expedited calibration
and repair



Includes PVA-1500HE2 PV Analyzer
and 1 year of Fluke Premium Care
FLUKE-PVA-1500/FPC



Includes PVA-1500HE2 PV Analyzer
and 3 years of Fluke Premium Care
FLUKE-PVA-1500/FPC3