

Instructions  
for  
**EDSYN<sup>INC</sup>®**  
FXF12  
FUMINATOR™  
Fume Extractor Fan



***Power Supply***

***Standard (U.S.A.)***

***-1 (No Transformer)***

***-100 (Japan)***

***-230 (Europe)***

***-230B (U.K.)***

***Solder not included***

*(Design, colors and materials subject to change without notice)*

**FXF12**  
**exploded view**

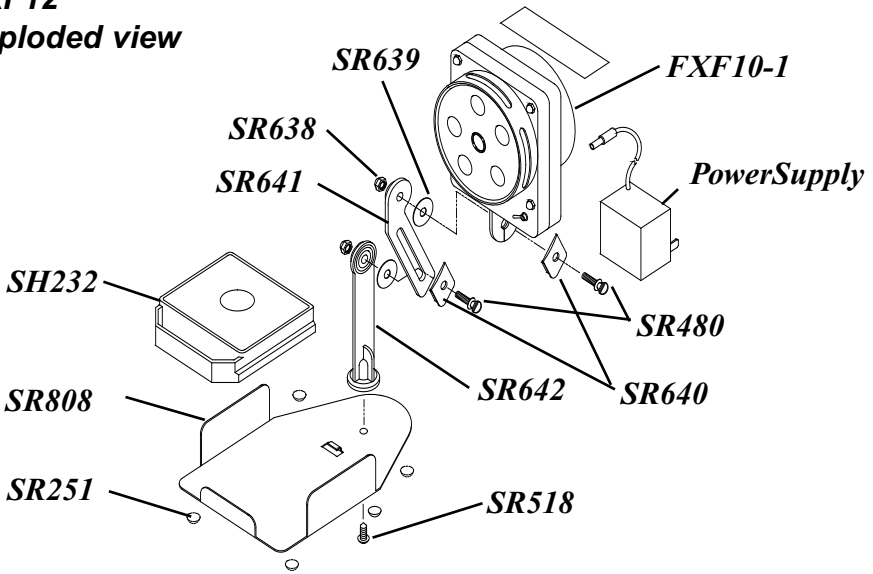

**XF01**  
**Filter Set**

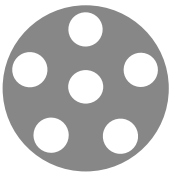

**XF02**  
*Primary Rotating Filter*

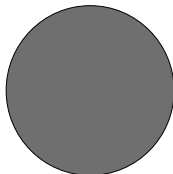

**XF03**  
*Charcoal Impregnated Stationary Filter*

**XF02**

**Primary Rotating Filter**

The XF02 filter element rotates at the same speed as the fan blades. Fumes and nail residues are evenly distributed.

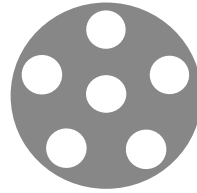

(set of 5)

**XF01** Filter Set with 1 - XF02 and 1 - XF03

**XF02** Primary Rotating Filter (set of 5)

**XF03** Charcoal Impregnated Stationary Filter (set of 5)

**power supply**

**SR571** for 100V (Japan)

**SR538** for 115V (U.S.A.)

**SR572** for 230V (Europe)

**SR821** for 230B (U.K.)

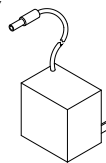

**XF03**

**Charcoal Impregnated Stationary Filter**

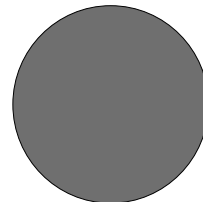

(set of 5)

**FXF10-1**  
*exploded view*

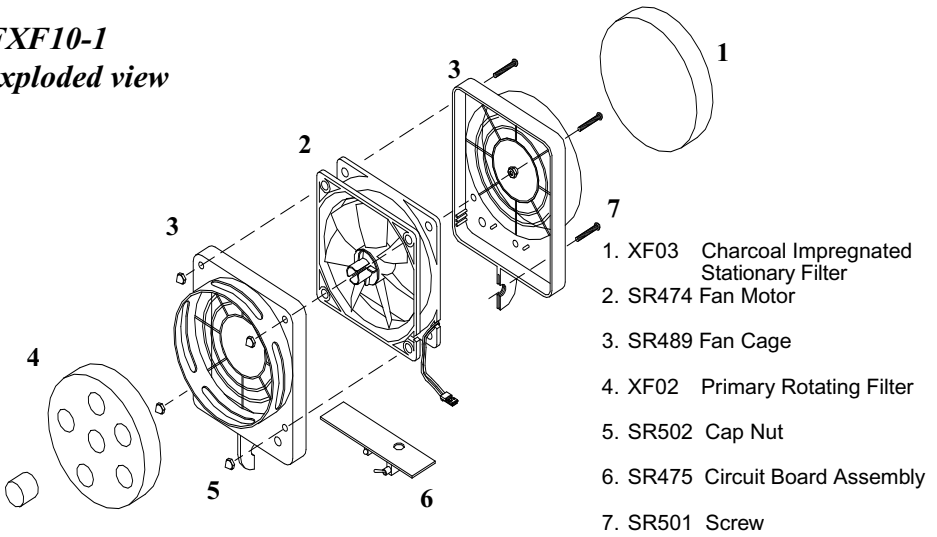

- 1. XF03 Charcoal Impregnated Stationary Filter
- 2. SR474 Fan Motor
- 3. SR489 Fan Cage
- 4. XF02 Primary Rotating Filter
- 5. SR502 Cap Nut
- 6. SR475 Circuit Board Assembly
- 7. SR501 Screw

**Filter Replacement**

1. Pull out dirty filter from hub when fan is off.
2. Replace with new XF02 Primary Rotating Filter

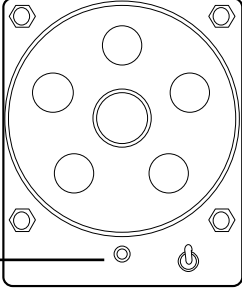

**Green LED**  
(indicates air flow towards fan)

**Front View**  
(air input)

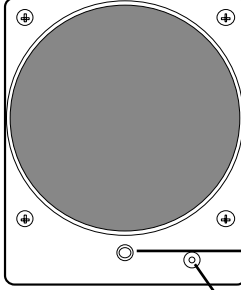

**Yellow LED**  
(indicates air flow away from fan)

**Rear View**  
(air output)

Universal 12VDC Input  
Jack Type: J4 Female 2.1 mm x 5.5 mm. Recommended 12VDC, 500mA Power Supply

**Variable Positioning**

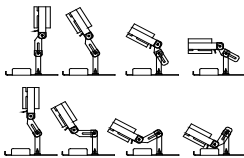

when extracting residue from the air.

**For Removing Fumes**

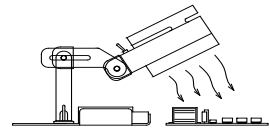

Position the FXF12 close to the working area to extract residue from the air.

The XF02 and XF03 filter elements can be used separately. For maximum filtration, install both filters.

## features

- Powerful 12V fan motor removes unwanted fumes, powder residues and odors from the air
- Can be used to either filter or blow dry clients nails
- Ultra-quiet operation
- Rotating front filter provides filtration eight times better than a stationary filter
- Bright front (green) and rear (yellow) LED's to indicate power and air flow direction
- Adjustable to almost any working angle
- Quick filter replacement
- Internal safety grills

## specifications

Power  
Requirements 12VDC

Overall  
Dimension 5.5"W x 12"H x 5.5"D  
140 mm x 305 mm x 140 mm

Weight 1.09 lbs (.49 kg)

Design, color and material subject to change  
without notice



**EDSYN** INC<sup>®</sup>

...the power of precision

**Test Equipment  
Depot**  
  
1-800-517-8431

99 Washington Street  
Melrose, MA 02176  
Phone 781-665-1400 Toll  
Free 1-800-517-8431